

## Screenflow Strainers

The Wedge Wire range of Screenflow strainers compliment our extensive range of process components including Tank Manways, Valves, Clamp fittings and Hygienic Unions.

Utilising fully interchangeable wedge wire elements, the Screenflow series offers slots tube sizes from 25 to 1000 Micron as standard. Intermediate and larger sizes are available on request.

The wedge wire principle is utilised in a wide variety of industrial applications and has proved highly successful in the brewing and beverage industry for fruit pith and particle removal. Wedge wire screens have also been used with some considerable success in smoothing high value products such as Shampoo and Creams in the cosmetic industry and Yoghurt and Soft Cheeses in the dairy industry.

Alchem offer a range of Screenflow strainers in 3", 4" and 6" housings. These housings offer a variety of flow capacities and attachment options to suit a range of process requirements.

High flow-rates and pressures are achievable with the wedge-wire screens and the robust construction of the cylindrical wedge-wire elements allows for high working pressures.

Back flushing is possible at up to 75% of the maximum working pressure.



### Universal Features

- Wide range of flow capacities
- No hand tools required to dismantle
- 25 Micron to 1000 micron standard slot tube elements
- Fully interchangeable elements
- Backflushing possible at up to 75% working pressure
- All 316L stainless steel construction
- Duplex arrangements for high flow conditions
- Jacketed housings offered for product heating
- Full range of FDA "Food Grade" seals
- Long life expectancy
- Range of surface finishes offered

Dimensions are provided in good faith but may be subject to change, if dimensions are critical please call the office to confirm all sizes before placing an order.

[DS S300 WW Filter V 1.3](#)

Page No: 1

## Screenflow 300 Strainer

Designed as our mid-range strainer and suitable for flow rates of up to 25M<sup>3</sup>/hour the Screenflow 300 series is designed as an affordable alternative to the competition. The strainer retains all of the features commonly associated with wedge wire screens.

The unit is utilised in a wide range of hygienic industries for particle removal whilst it has also proved particularly successful in smoothing high value products such as Shampoo and Creams, Yoghurt and Soft Cheeses.

The strainer is available in the two standard installation designs namely the 90° "L Pattern" and In-line "Y Pattern". A fabrication service is offered for specials including extended housings, heated water jackets, stands and frames, duplex and triplex arrangements.

Bleed valves can also be fitted to vent excessive heat, pressures and product build up.

A full range of FDA food grade seals are offered and connections in Clamp, RJT, IDF/ISS, DIN 11851, DIN 11864 and SMS fittings available as standard, with flanged and BSP connections supplied to order.

### Main features and options:

- Fully Interchangeable wedge wire elements
- High flow-rate capacity up to 25 M<sup>3</sup>/H
- Standard Inlet sizes from 1", 1.1/2" and 2"
- Standard slot tubes sizes from 25 to 1000 micron
- All 316L stainless steel construction
- Jacketed housings and duplex arrangements
- Metal to metal housing to element seating
- No tools required for dismantling and servicing
- Full range of FDA food grade seals
- Range of surface finishes offered
- Backflushing possible at up to 75% working pressure
- 7 Bar working pressure
- Fully welded and robust wedge wire element

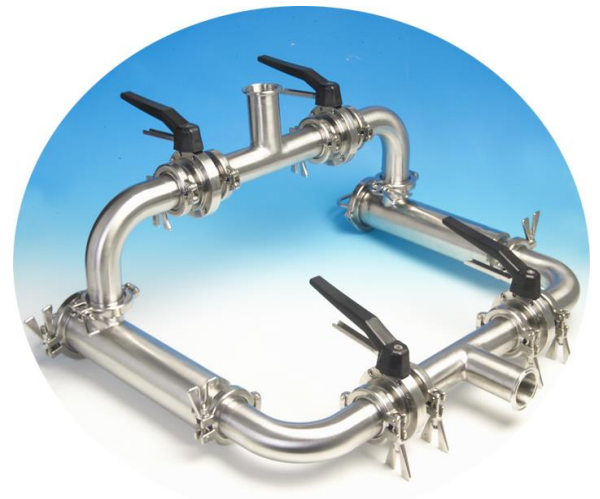

**Duplex strainer arrangement**

### Special options:

- Special elements produced for critical product filtration
- Full range of filter element sizes from 25 to 3000 Micron
- Duplex and triplex arrangements made to suit your application
- Stands and frames fabricated to suit your needs
- Special extended filter bodies available to suit your application

Dimensions are provided in good faith but may be subject to change, if dimensions are critical please call the office to confirm all sizes before placing an order.

[DS S300 WW Filter V 1.3](#)

Page No: 2

## Screenflow Strainer – 90° L Pattern

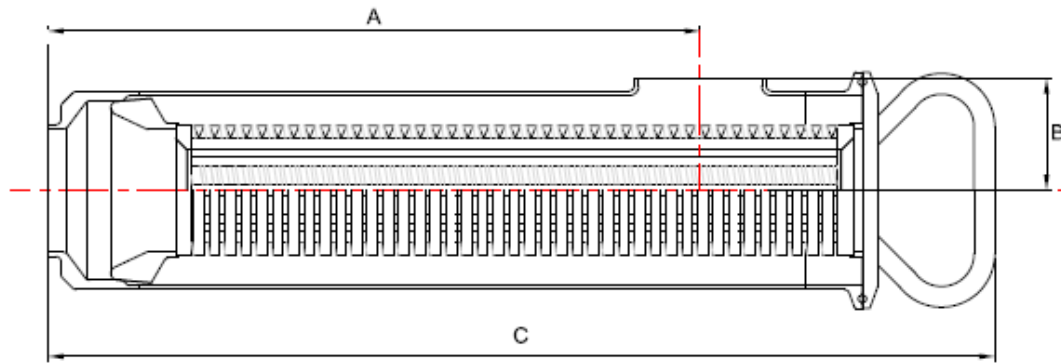

Part No:	Pipeline Size	Body Size	A	B	C	Series
2080-A026	1"	3"	299	43	412	S300
2080-A038	1.1/2"	3"	281	43	394	S300
2080-A051	2"	3"	251	43	364	S300
2085-A051	2"	4"	251	54	364	S400
2085-A064	2.1/2"	4"	251	54	364	S400
2085-A076	3"	4"	251	54	364	S400
2087-A051	2"	5"	560	68	620	S500
2087-A064	2.1/2"	5"	535	68	595	S500
2087-A076	3"	5"	540	68	600	S500
2087-A102	4"	5"	460	68	520	S500
2087-A051	2"	6"	560	80	620	S600
2087-A064	2.1/2"	6"	535	80	595	S600
2087-A076	3"	6"	540	80	600	S600
2087-A102	4"	6"	460	80	520	S600

### Options:

- High Flow rate capacity
- Choice of FDA approved seal materials
- Wedge wire elements from 25 Micron to 3000
- 7 Bar working pressure
- Standard dull polished finish
- Duplex systems manufactured to aid CIP cleaning and high flow requirements
- **Final dimension to be confirmed at order stage**

Viton® is a registered trade mark of Dupont Dow Elastomers

Dimensions are provided in good faith but may be subject to change, if dimensions are critical please call the office to confirm all sizes before placing an order.

## 2081- Screenflow 300 Y Pattern

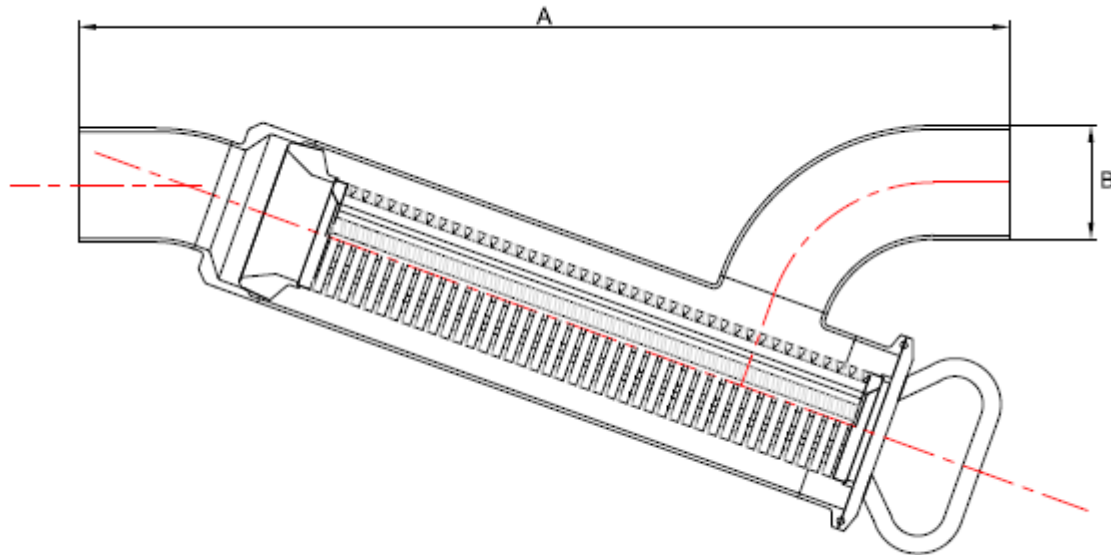

Part No:	Pipeline Size	Body Size	A	B	C	Series
2080-A026	1"	3"	415	185		S300
2080-A038	1.1/2"	3"	415	200		S300
2080-A051	2"	3"	420	200		S300

### Options:

- High Flow rate capacity
- Choice of FDA approved seal materials
- Wedge wire elements from 25 Micron to 3000
- 7 Bar working pressure
- Standard dull polished finish
- Duplex systems manufactured to aid CIP cleaning and high flow requirements
- **Final dimension to be confirmed at order stage**

Dimensions are provided in good faith but may be subject to change, if dimensions are critical please call the office to confirm all sizes before placing an order.

[DS S300 WW Filter V 1.3](#)

Page No: 4

## 2083 ST Strainers – Straight Through

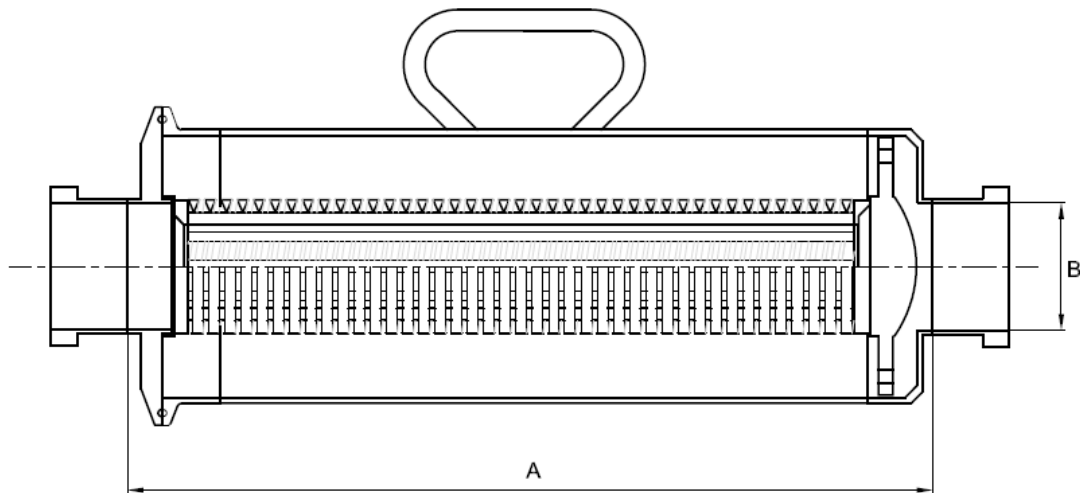

Part No:	Line Size	A	B	C	Series
2083-A026	1"				S400
2083-A038	1 1/2"				S400
2083-A051	2"				S400
2083-A064	2 1/2"				S400
2083-A076	3"				S600
2083-A102	4"				S600

### Options:

- High Flow rate capacity
- Choice of FDA approved seal materials
- Wedge wire elements from 25 Micron to 3000
- 7 Bar working pressure
- Standard dull polished finish
- Duplex systems manufactured to aid CIP cleaning and high flow requirements
- **Final dimension to be confirmed at order stage**

Dimensions are provided in good faith but may be subject to change, if dimensions are critical please call the office to confirm all sizes before placing an order.

[DS S300 WW Filter V 1.3](#)

Page No: 5

## Pump Protection Strainers

These compact mini-strainers are frequently used for pump protection and where space is at a premium. The strainer is useful where flow rates seldom exceed 10 M<sup>3</sup>/hour. The standard Wedge Wire element ratings range from 50 to 2000 Micron and specials can be manufactured to suit your particular application.

Housings are available to suit 3" and 4" connections sizes.

Perforated elements can also be supplied in 1.0mm, 1.5mm, 3.0mm and 10.0mm ratings.



### Features and options:

- Compact design suitable for confined spaces
- Ideal for pump protection duties
- Fully Interchangeable wedge wire elements
- Flow rate capacity up to 10M<sup>3</sup>/H
- Standard Inlet sizes from 1", to 4"
- Standard slot tubes sizes from 50 to 750 micron
- All 316L stainless steel construction
- Jacketed housings and duplex arrangements
- Metal to metal housing to element seating
- No tools required for dismantling and servicing
- Full range of FDA food grade seals
- Long life expectancy
- Range of surface finishes offered
- Backflushing possible at up to 75% working pressure
- 7 Bar working pressure
- Fully welded and robust wedge wire element

Dimensions are provided in good faith but may be subject to change, if dimensions are critical please call the office to confirm all sizes before placing an order.

[DS S300 WW Filter V 1.3](#)

Page No: 6